

**BLOCK B - MEDIA CENTER: TILLING LAYOUT**  
Scale 1: 100

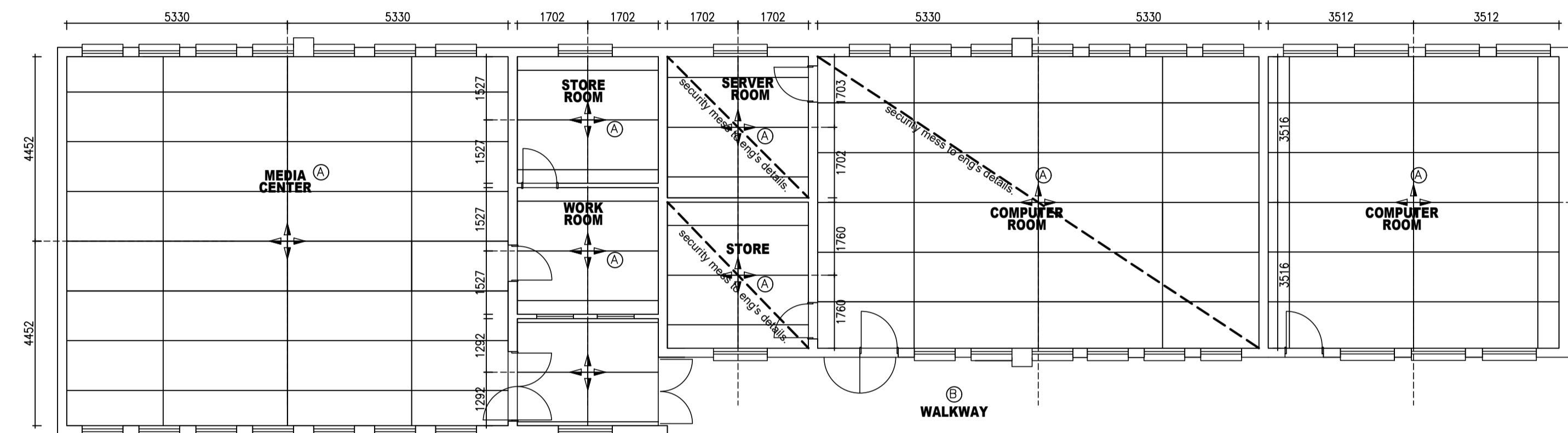

**BLOCK B - MEDIA CENTER: CEILING LAYOUT**  
Scale 1: 100

Door no.:	01	Gate no.:	01	Door no.:	02	Gate no.:	02	Door No.:	03
FRAME	Standard door frame 1.	FRAME	Galvanised. Not painted	FRAME	Double door frame.	FRAME	Galvanised. Not painted	FRAME	Standard door frame 1.
FRAME FINISH	STD Galvanized Steel door frame, suitable for double skin wall.	FRAME FINISH	Galvanised. Not painted	FRAME FINISH	Gloss enamel paint.	FRAME FINISH	Galvanised. Not painted	FRAME FINISH	Standard Galvanized Steel door frame, suitable for single skin wall.
DOOR	2032 x 813 x 40mm Standard approved "meranti" ledged and braced batten door with: 40x110mm styles and top rail, 20x150mm middle ledge, 20x225mm bottom ledge and 20x110mm braces.	DOOR	2125h Purpose made gms single gate, for a 900 mm structural opening, complete with hinges & locking mechanism, all to manufacturers specifications.	DOOR	Two (2032 x 813 x 40mm) Standard approved "meranti" ledge and braced batten door with : 40 x 110mm styles and top rail 20 x 150mm middle ledge, 20 x 225mm bottom ledge and 20 x 110mm braces.	DOOR	2125h Purpose made gms single gate, for a 1890 mm structural opening, complete with hinges & locking mechanism, all to manufacturers specifications.	DOOR	2032 x 813 x 40mm Solid flush panel door with approved hardwood veneer both sides and two hardwood edge strips.
DOOR FINISH	2 Coats clear mat varnish.	DOOR FINISH	Galvanised. Not painted	DOOR FINISH	2 Coats clear mat varnish.	DOOR FINISH	Galvanised. Not painted	DOOR FINISH	2 Coats clear mat varnish.
FURNITURE	Classrooms : 4 Lever Union Lockset, x1 Rubber door stopper. Provide leaf spring door holder. Hinges as per manufacture.	FURNITURE	2 lever deadlock, 1x 38mm red rubber door stop on wall, manufacture.	FURNITURE	DOOR SET 4. and leaf spring door holders.	FURNITURE	2 lever deadlock, 2x 38mm red rubber door stop on wall, manufacture.	FURNITURE	Store Rooms : 3 Lever Union Lockset, x1 Rubber door stopper. Provide leaf spring door holder. Hinges as per manufacture.
QUANTITY	X04	QUANTITY	X03	QUANTITY	X1	QUANTITY	X02	QUANTITY	X04
Window No.:	SS32	Window No.:	SS41	Window No.:	SS23	Window No.:	SS44	Window No.:	SS43
FRAME	Durowin Standard steel 21 internally glazed industrial hot dip galvanised residential profile purpose made windows.	FRAME	Durowin Standard steel 21 internally glazed industrial hot dip galvanised residential profile purpose made windows.	FRAME	Durowin Standard steel 21 internally glazed industrial hot dip galvanised residential profile purpose made windows.	FRAME	Durowin Standard steel 21 internally glazed industrial hot dip galvanised residential profile purpose made windows.	FRAME	Durowin Standard steel 21 internally glazed industrial hot dip galvanised residential profile purpose made windows.
GLASS	4mm "Safety Glass" glass puttied in with steel window putty.	GLASS	4mm "Safety Glass" glass puttied in with steel window putty.	GLASS	4mm "Safety Glass" glass puttied in with steel window putty.	GLASS	4mm "Safety Glass" glass puttied in with steel window putty.	GLASS	3mm Clear float glass puttied in with steel window putty.
FITTINGS	Approved standard chrome plated fittings to suite opening sashes.	FITTINGS	Approved standard chrome plated fittings to suite opening sashes.	FITTINGS	Approved standard chrome plated fittings to suite opening sashes.	FITTINGS	Approved standard chrome plated fittings to suite opening sashes.	FITTINGS	Approved standard chrome plated fittings to suite opening sashes.
BURGLAR BARS	10mm Square burglar bars at 150mm centres to be fully burglar barred.	BURGLAR BARS	10mm Square burglar bars at 150mm centres to be fully burglar barred.	BURGLAR BARS	10mm Square burglar bars at 150mm centres to be fully burglar barred.	BURGLAR BARS	10mm Square burglar bars at 150mm centres to be fully burglar barred.	BURGLAR BARS	10mm Square burglar bars at 150mm centres to be fully buglar barred.
FINISH	Galvanised. Not painted	FINISH	Galvanised. Not painted	FINISH	Galvanised. Not painted	FINISH	Galvanised. Not painted	FINISH	Gloss enamel paint.
QUANTITY	x27	QUANTITY	x09	QUANTITY	x02	QUANTITY	x07	QUANTITY	x04
LOCATION	See Layout	LOCATION	See Layout	LOCATION	See Layout	LOCATION	See Layout	LOCATION	See Layout

#### General Notes

Ridge Capping:  
AG150 G550 zincalume ridge capping with broad flute closures to suit roof profile

Roof Covering:  
Chromadek (10.5) corrugated 0.8mm thick ISO230, Z275 spelter galvanized steel roof sheeting with chromadek finish to one side and protective primer coating on reverse side, "SKY BLUE", fixed to timber purlins (wind-load to be taken into account). Matching chromadek purpose made barge flashing on all gables to detail

Roof Membrane:  
One layer of 250 micron Consol Plastics Brikgrid DPC embossed damp proof course

Roof and wall Sasilation:  
"Sasilation 420" heavy industrial grade aluminium foil based Insulation

Trusses:  
114x38mm Timber roof rafters by specialist spaced @ max 1.2mmcc. Size of timbers to be confirmed by eng. Pitch 8°

Paint to exposed Rafters :  
Two coats "ABE provonite" paint on exposed roof timbers and wall plates.

Internal purlins:  
Intermediate purlins at equal centres with ridge and end purlins as per roof manufacturer's spec. (wind-loading to be considered)

Ceilings: (Where Applicable)  
4.5mm Nutec ceiling board, fixed to 38x50mm brandering at max 400cc including "H" profile jointing strips all to manufacturers instructions.

and

4.5mm Nutec Ceiling Board fixed to 38x50mm brandering at max 400cc including "H" profile jointing strips all to manufacturers instructions.

Air-brick:  
2 Terracota Air-bricks

and

4 Terracotta air-bricks spaced between trusses.

Barge Boards:  
Un-painted fibre cement socketless barge boards.

Windows:  
Galvanized steel windows to window schedule detail and specification.

Water Protection on Windows:  
One layer of 375 micron green polyethylene waterproof sheeting (SANS 952-1985 type C) sealed at laps with PVC self-ache

Gutters:  
Seamless 155 x 100 x 115mm aluminium ogee gutter with baked enamel finish fixed with concealed brackets - all to suppliers specification, with Ø80mm Pvc downpipes with 1 No. to discharge into water tanks and water channel.

RWDPP's:  
100x75mm PVC aluminium down pipes, 1 No. to discharge into water hannel.

External Walls:  
Face Brick 30-40MPa Fireside Travertine Imperial and, MAIZE TRAVERTINE FBX size 222x 106 x 73mm, bedded and jointed in Class II mortar and pointed with recessed vertical and recessed horizontal joints, suitable for exposure zones 1-2.

Internal Walls:  
6-8mm please to all internal walls

Prepare surfaces and remove all loose material, apply one coat Wall and All Pure Acrylic' thinned 20% and one coat Wall and All Pure Acrylic' paint or equal and approved:

and

Prepare surfaces and remove all loose material, apply one coat 'Merit Plaster Primer' and two coats Double Velvet Pure Acrylic' paint or equal and approved:

and  
Face brick on edge lintel, above all wind & doors.

and  
face brick on edge to external sills.

Floor Slabs:  
See civil engineering drawings.

Floor Membrane:  
Sikaflex-PRO2HP polyurethane joint sealant filling to 6 x 30mm deep saw cut in top of concrete surface bed, including neatly pointing

Floor Finish:

Tiles -  
3mm thick x 300mm x 300mm wide Floorflex semi- flexible vinyl floor tiles laid in Marley No.60 Plus acrylic adhesive spread with trowel having 1.5mm x 1.5mm x 1.5mm triangular notches at 4.00mm centres as per Architectural and Manufacturers specifications

Skirting:  
19 x 76mm Skirting with 19mm quadrant bead, plugged

Soft-board:  
10mm impregnated soft-board between brickwork and concrete

Concrete Channels:  
In-situ concrete water channels to detail. (See Civil Drawings)

Steel Column:  
100x100mm hollow steel galvanised steel column, to engineer's fixing details.

Industrial Sink:  
SINGLE POT SINK with Mid Steel Legs(No Shelf), code- SDSN901607.

Industrial Sink Tap:  
Kitchen tap DELINIA Thomas chrome, code - SKU 81444268.

Wall Tiles:  
Shiny white ceramic tiles - 200x200mm shiny finish, code: WS1OSH100L.

#### REVISIONS

	DATE	DESCRIPTION
0A	30 AUG. 22	ISSUED FOR TENDER

#### CLIENT:

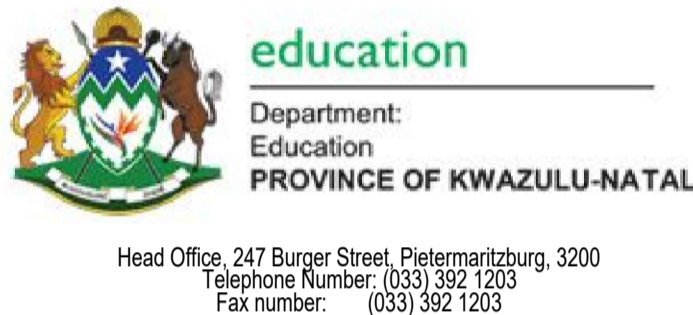

Head Office, 247 Burger Street, Pietermaritzburg, 3200  
Telephone Number: (033) 392 1203  
Fax number: (033) 392 1203

#### IMPLEMENTING AGENT:



Headway Hill, 1258 Lever Road, Midrand, South Africa  
Telephone Number: +27 11 313 3911  
Fax number: +27 11 313 3500 or +27 11 313 3297  
Web: webmaster@dbsa.org

#### PRINCIPAL AGENT:



Regus Westway, -3 Floor,  
18 The Boulevard, Westway Office Park  
Tel +27 31 003 3138  
Fax +27 31 003 3101  
Email - nothile@bhadama.co.za/ sbu@bhadama.co.za

#### PROJECT NAME & CLIENT INFORMATION KZN-DOE/DBSA - STORM DAMAGE PROGRAMME

#### SECTION / BLOCK EZAKHELENI PS- BLOCK B MEDIA CENTER+ CLASSRM

#### TITLE GENERAL LAYOUTS & DETAILS

#### DRAWING DESCRIPTION TILLING & CEILING LAYOUT, WINDOW and DOOR SCHEDULE.

SCALE	AS SHOWN			
DESIGNED	DATE	PrEng No.	SIGN.:	
NM	AUG. 2022			
DRAWN	DATE	SACAP NO.	SIGN.:	
NM	AUG. 2022			
APPROVED	DATE	DRAWN:	SIGN.:	
NM	AUG. 2022	NM		
DRAWING NUMBER:			REVISION	
KZN.DoE/ DBSA-BPP- EPS- B- L&F-005-0A			0A	

#### PREPARED BY:



Unit, no. 27  
Pallana Velly, 01 Robertson Road, New Germany, 3610  
cell: 062 1826 167 - Fax: 086 762 552  
Email: nkulileko@kandzprojects.co.za

**FOR TENDER "ONLY"**